

# HOW TO USE THE InvisiClose® Tail Closure System

These instructions apply to both the Natura® ostomy system and Esteem synergy® ostomy system with InvisiClose® Tail Closure System.

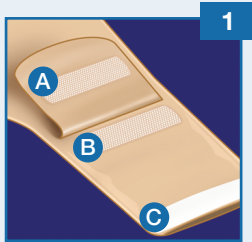

## TO CLOSE THE POUCH

1. The InvisiClose® tail closure system is comprised of a security flap **A**, inter-locking closures **B** and outlet end-strips **C**.

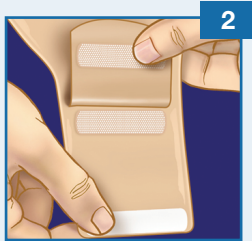

2. Hold the security flap against the front of the pouch revealing the inter-locking closures.

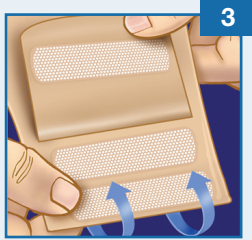

3. Fold the tail end up towards you four times and ensure the inter-locking closures overlap.

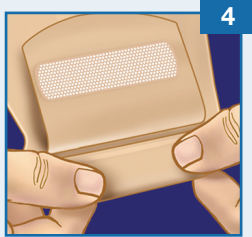

4. Press the inter-locking closures together until you feel them lock (click) into place along their entire length.

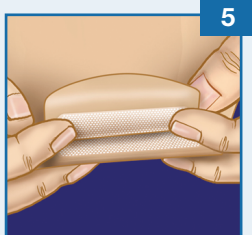

5. Wrap the security flap around to the back of the pouch (**body side**) and press the inter-locking closures together until you feel them lock (**click**) into place.

# HOW TO USE THE InvisiClose® Tail Closure System

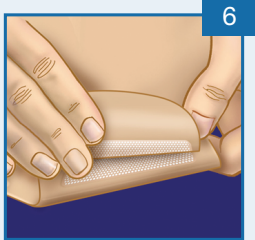

## TO DRAIN THE POUCH

6. Turn the back of the pouch (**body side**) towards you. Carefully lift the security flap up towards you to unlock.

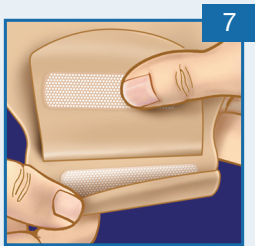

7. Hold the security flap against the front of the pouch. While holding the security flap up against the front of the pouch, unlock the inter-locking closure by lifting at the corner and unraveling the folds four times.



8. To facilitate draining and/or cleaning, you may open the tail end by pushing in both ends of the outlet end-strips with your thumb and forefinger. If desired, the pouch tail may be cleaned with gentle soap and water. Pat dry.



For more information, please call our Customer Relations Center (Registered Nurses on staff) at **1-800-465-6302**, Monday through Friday, 8:00 AM to 6:00 PM (EST), or visit our Web Site at **[www.convatec.ca](http://www.convatec.ca)**

See package insert for complete instructions.

® indicates trademark of ConvaTec Inc.  
© 2016 ConvaTec Inc.

V582

