

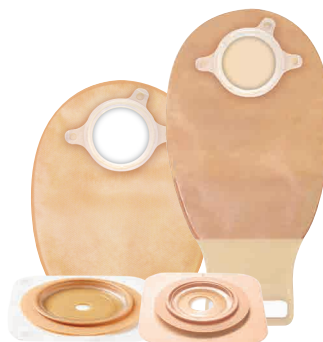

NATURA™

Cut-To-Fit Accordion Baseplate



1

Accordion baseplate application

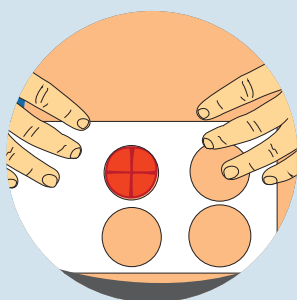

Measure the stoma and select the appropriate size baseplate.

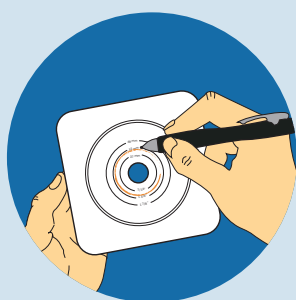

Trace the stoma size on the centre of the white release paper on the reverse of the baseplate, then cut 1/8" (3mm) larger than your tracing.

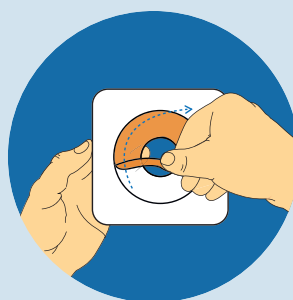

Peel off release liner and centre the opening over the stoma. Apply to clean dry skin.

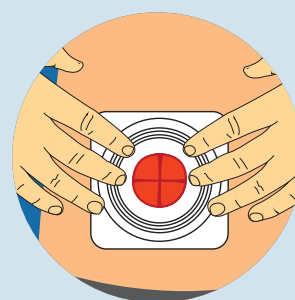

Remove white release paper and press against the skin. Smooth the tape collar and hold the baseplate in place for 30 seconds.

2

Closing a drainable pouch

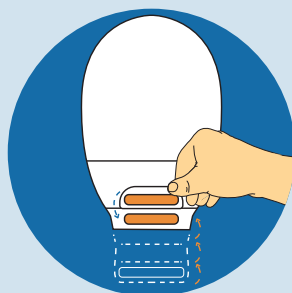

Roll the end up towards the pouch until the interlocking closures line up. Press and pinch around the closure to secure.

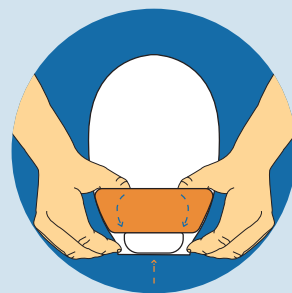

Turn the Lock-it-Pocket™ inside-out to tuck tail inside.

TIP
If using a drainable pouch over a closed pouch, we recommend you close the tail closure before applying your pouch to the baseplate.

3

Applying and wearing the pouch

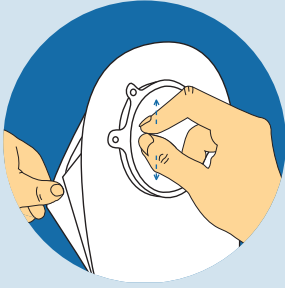

Separate the sides of the pouch to allow some air to enter.

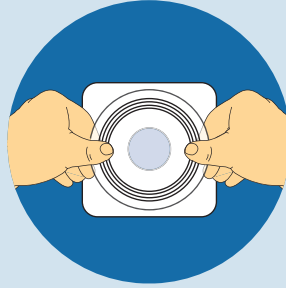

PULL UP Accordion baseplate and hold with thumbs on top and fingers underneath. Align coupling of pouch and baseplate.

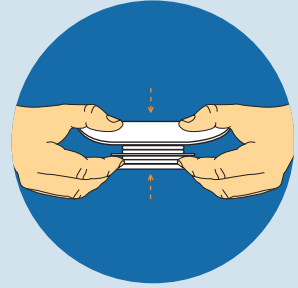

Start at the bottom and apply pressure around the coupling until the pouch and baseplate snap together. Then place the Accordion Baseplate in the **DOWN** position for a flat profile.

4

Emptying and cleaning a drainable pouch

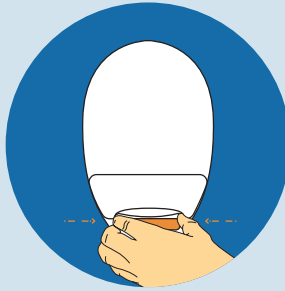

To empty pouch, tilt the tail up towards your body. Peel open the closure and unravel tail. Unlock pouch closure and open the tail by pushing in both ends of the outlet end-strips with fingers; drain pouch.

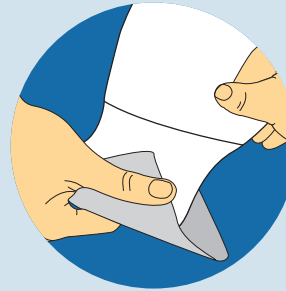

Tips for cleaning the pouch: Support the pouch with one hand and wipe tail of pouch in firm downward motion with toilet tissue in other hand.

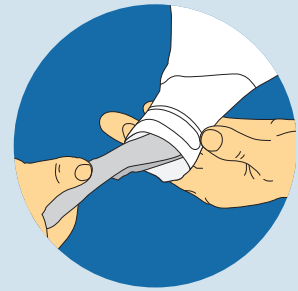

Clean the inside surface of tail with moist toilet tissue.

5

Removing the pouch



To remove the pouch from the baseplate, hold the baseplate down with one hand and gently un-snap the pouch. Only remove the pouch if replacing with a new, clean pouch.

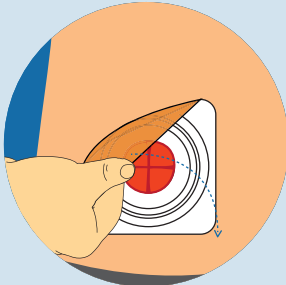

Gently pull the skin barrier down, away from the skin while supporting the adjacent skin with your other hand. Only remove the baseplate if replacing with a new, clean baseplate.

**TIP**

To ensure easy removal of the baseplate use ConvaTec Niltac™ Adhesive Removal where appropriate.