

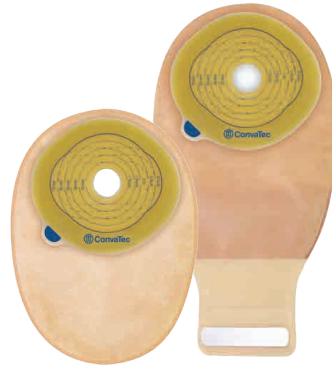

ESTEEM™

With Pre-Cut or Cut-To-Fit Baseplate



1

Getting the right fit

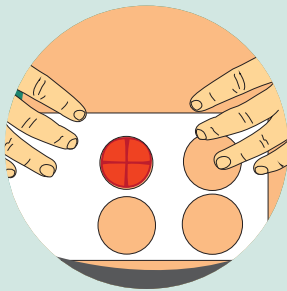

Measure the stoma and select the appropriate size baseplate.

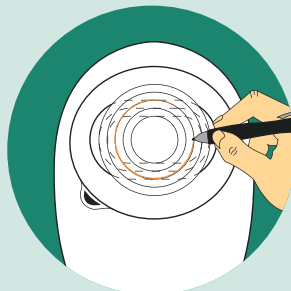

Cut-to-fit baseplate:

Trace the stoma size on the centre of the clear release line on the reverse of the baseplate, then cut an opening about 1/8" (3mm) larger than your tracing.

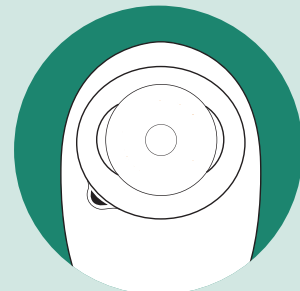

Pre-cut baseplate:

Select baseplate with pre-cut opening slightly larger than your stoma.

2

Closing a drainable pouch

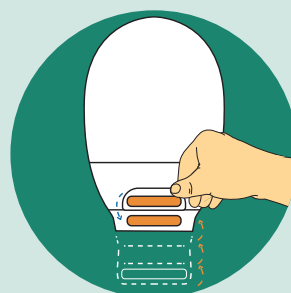

Roll the end up away from your body until the interlocking closures line up. Press and pinch around the closure to secure.



Turn the Lock-it-Pocket™ inside-out to tuck tail inside.

TIP

If using a drainable pouch over a closed pouch, we recommend you close the tail closure before applying your pouch to the baseplate.

3 Applying and wearing the pouch

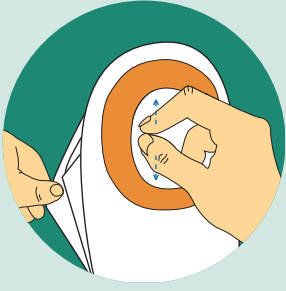

Separate the sides of the pouch to allow some air to enter.



Remove the clear release liner from the baseplate by pulling up on the blue tab.

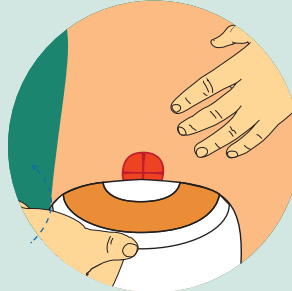

Place the pouch gently in position over the stoma.



Press the baseplate against the skin. Smooth the inner edge closest to your stoma then hold for 30 seconds to ensure a snug fit.

4 Emptying and cleaning a drainable pouch

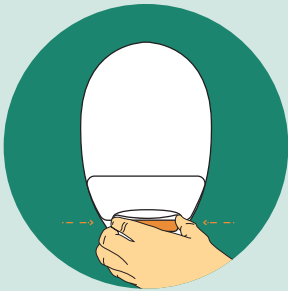

To empty pouch, tilt the tail up towards your body. Peel open the closure and unravel tail. Unlock pouch closure and open the tail by pushing in both ends of the outlet end-strips with fingers; drain pouch.

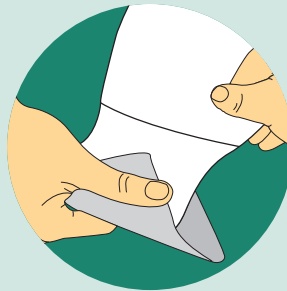

Tips for cleaning the pouch: Support the pouch with one hand and wipe tail of pouch in firm downward motion with toilet tissue in other hand.

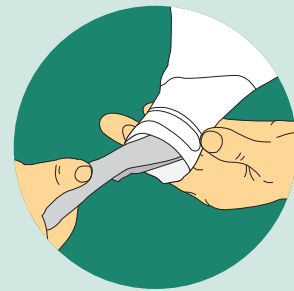

Clean in inside surface of tail with moist toilet tissue.

5 Emptying and removing the pouch



Gently pull the baseplate down, away from the skin while supporting the adjacent skin with your other hand.



TIP
To ensure easy removal of the baseplate use ConvaTec Niltac™ Adhesive Removal where appropriate.

For more information, call us on - 0800 282 254