

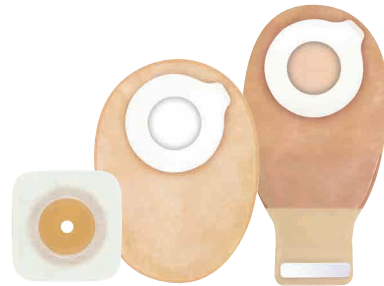

# ESTEEM SYNERGY™

With Pre-Cut or Cut-To-Fit Baseplate



## 1 Applying the baseplate

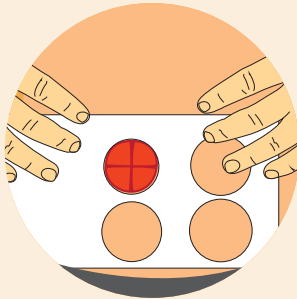

Measure the stoma and select the appropriate size baseplate.

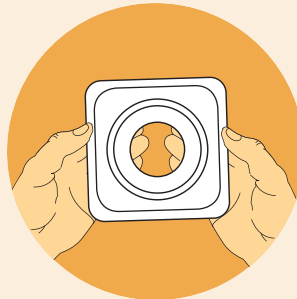

**Pre-cut baseplate:**  
Select baseplate with pre-cut opening slightly larger than your stoma.

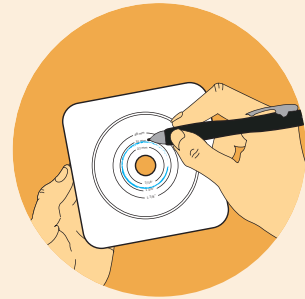

**Cut-to-fit baseplate:**  
Trace the stoma size on the centre of the clear release line on the reverse of the baseplate, then cut an opening about 1/8" (3mm) larger than your tracing.

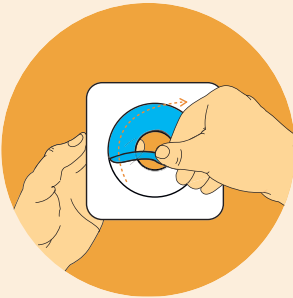

Remove the clear release liner from the back of the baseplate and centre the opening over your stoma.

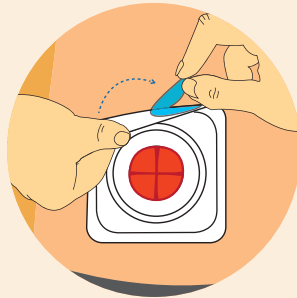

Press the baseplate into place and if necessary re-adjust to create a snug fit.



Press gently against skin, smoothing out any wrinkles.

## 3 Closing a drainable pouch



**TIP**  
If using a drainable pouch over a closed pouch, we recommend you close the tail closure before applying your pouch to the baseplate.

Fold the end up towards you until the interlocking closures line up. Press and pinch around the closure to secure.



Turn the Lock-it-Pocket™ inside-out to tuck tail inside.

2

## Applying and wearing the pouch



Separate the side of the pouch to allow some air to enter.

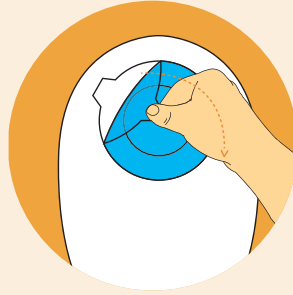

Remove the release paper from the adhesive ring on the pouch.



Softly fold the adhesive ring, apply the lower half to the bottom of the landing zone, then "roll or slide" your fingers over the upper portion to secure the pouch.

4

## Emptying and cleaning a drainable pouch

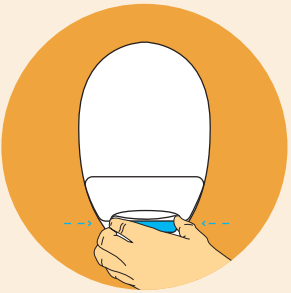

To empty pouch, tilt the tail up towards your body. Peel open the closure and unravel tail. Unlock pouch closure and open the tail by pushing in both ends of the outlet end-strips with fingers; drain pouch.

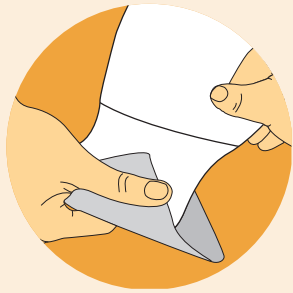

**Tips for cleaning the pouch:** Support the pouch with one hand and wipe tail of pouch in firm downward motion with toilet tissue in other hand.

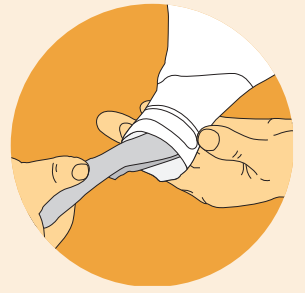

Clean the inside surface of tail with toilet tissue or baby wipe.

5

## Emptying and removing the pouch



To remove pouch, peel from the landing zone by holding the tab on the adhesive ring with one hand on the edge of the transparent landing zone. Peel the pouch downward with a top-to-bottom rolling motion.

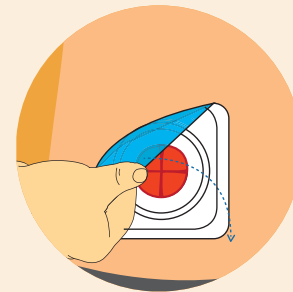

To remove baseplate, gently lift the corner and peel away whilst pressing down on the skin.

**Only remove the pouch or baseplate if replacing with a new, clean pouch or baseplate.**



### TIP

To ensure easy removal of the baseplate use ConvaTec Niltac™ Adhesive Removal where appropriate.

For more information, call us on - 0800 282 254