



neria™ detach infusion sets

The neria™ detach infusion set is a steel needle infusion set with a disconnect option making it possible to disconnect from the pump without removing the infusion set. The neria™ detach infusion set is inserted at a 90 degree angle.

Product Specifications

Cannula:	Stainless Steel	Adhesive:	Built-in, skin friendly ¹ non-woven polyester, acrylic adhesive
Insertion angle:	90 degrees (straight in)		
Disconnection:	Yes		

Gauge size	Needle lengths	Tubing lengths	Priming volumes
G27	6, 8 and 10 mm	60, 80 and 110 cm	60 cm ~ 0.10 ml 80 cm ~ 0.12 ml 110 cm ~ 0.15 ml

The neria™ detach infusion sets are sold in boxes containing 10 sets.

Reference: ¹ Biological Safety Testing, October 2011, Data on File, Unomedical a/s.

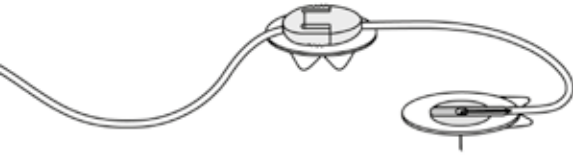

neria™ detach infusion sets user steps

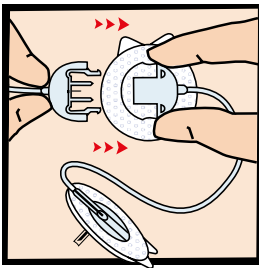

1. Connect the connector needle with the coupling housing.

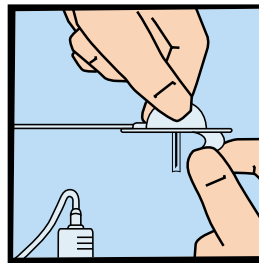

2. Prime the tube according to pump manufacturer's instructions for use and remove the adhesive backing paper.

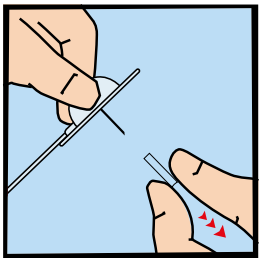

3. Gently twist and pull to remove the needle guard.

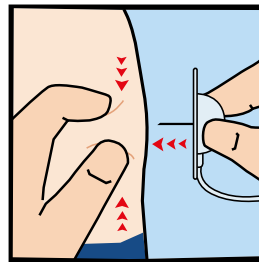

4. Pinch the skin with one hand and insert neria™ detach infusion set vertically.

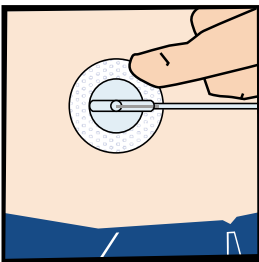

5. Press the adhesive to secure neria™ detach infusion set to the skin. Check the infusion site frequently.

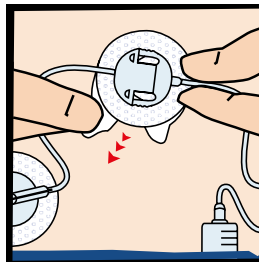

6. Remove the adhesive from the coupling housing and place coupling housing on the skin.

Please note that this guide only illustrates some of the steps to follow when inserting the neria™ detach infusion sets and it is not a substitute for reading the instructions for use which comes with the product.

neria is a trademark of Unomedical a/s © ConvaTec Inc. 2017 AP-018225-MM