

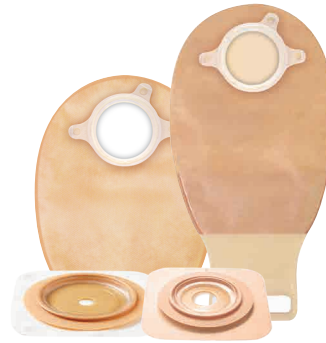

NATURA™

MOULDBLE BASEPLATE
WITH ACCORDION FLANGE



1 Accordion baseplate application

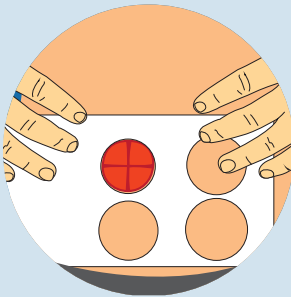

Measure the stoma and select the appropriate size baseplate. There is a clear release liner on back of baseplate: do not remove yet.

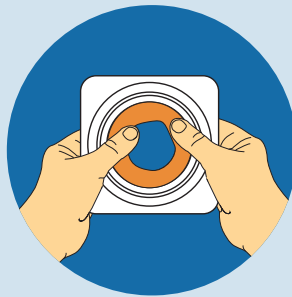

For a custom fit roll and shape the Mouldable Technology™ to the size and shape of your stoma. **Do not stretch, pull or cut.**

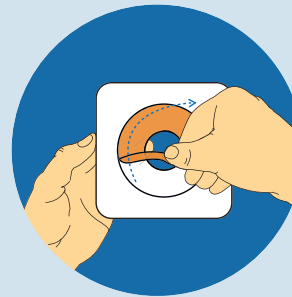

Peel off clear release liner and centre the opening over the stoma. Apply to clean dry skin.

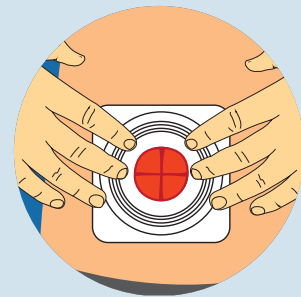

Remove white release paper. Press the baseplate into place and if necessary re-adjust the Mouldable Technology™ to create a snug fit. Smooth and hold the baseplate in place for 30 seconds.

2 Closing a drainable pouch

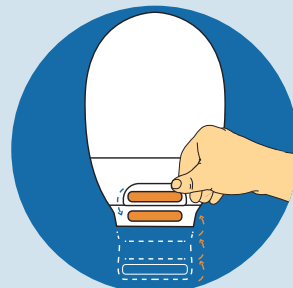

TIP
If using a drainable pouch over a closed pouch, we recommend you close the tail closure before applying your pouch to the baseplate.

Roll the end up towards the pouch until the interlocking closures line up. Press and pinch around the closure to secure.

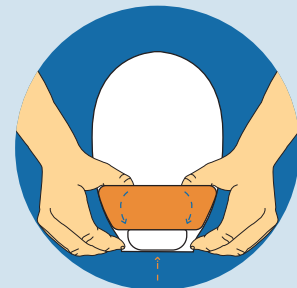

Turn the Lock-it-Pocket™ inside-out to tuck tail inside.

3 Applying and wearing the pouch

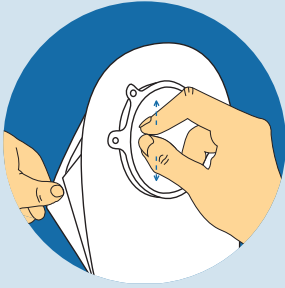

Separate the sides of the pouch to allow some air to enter.

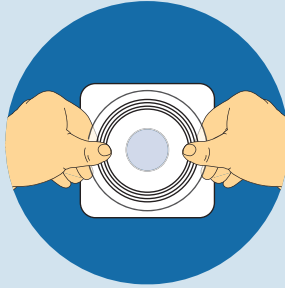

PULL UP Accordion baseplate and hold with thumbs on top and fingers underneath. Align coupling of pouch and baseplate.

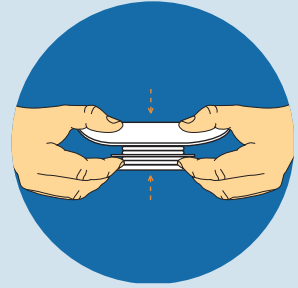

Start at the bottom and apply pressure around the coupling until the pouch and baseplate snap together. Then place the Accordion baseplate in the **DOWN** position for a flat profile. **Always double check the coupling is completely closed, if not repeat the steps.**

4 Emptying and cleaning a drainable pouch

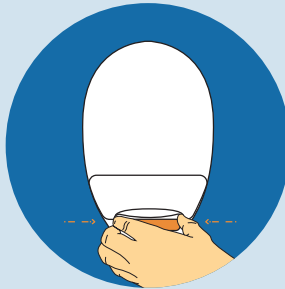

To empty pouch, tilt the tail up towards your body. Peel open the closure and unravel tail. Unlock pouch closure and open the tail by pushing in both ends of the outlet end-strips with fingers; drain pouch.

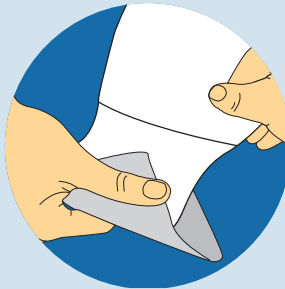

Tips for cleaning the pouch: Support the pouch with one hand and wipe tail of pouch in firm downward motion with toilet tissue in other hand.

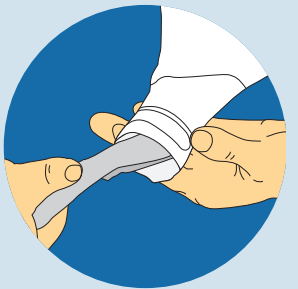

Clean the inside surface of tail with moist toilet tissue.

5 Removing the pouch



To remove the pouch from the baseplate, hold the baseplate down with one hand and gently un-snap the pouch. Only remove the pouch if replacing with a new, clean pouch.

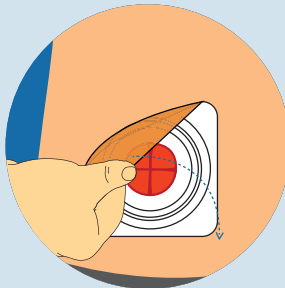

Gently pull the baseplate down, away from the skin. While supporting the adjacent skin with your other hand. Only remove the baseplate if replacing with a new, clean baseplate.



TIP
To ensure easy removal of the baseplate use ConvaTec Niltac™ Adhesive Removal where appropriate.

For more information, call us on - 0800 282 254